

Rplate Essential Installation & Setup

In the box

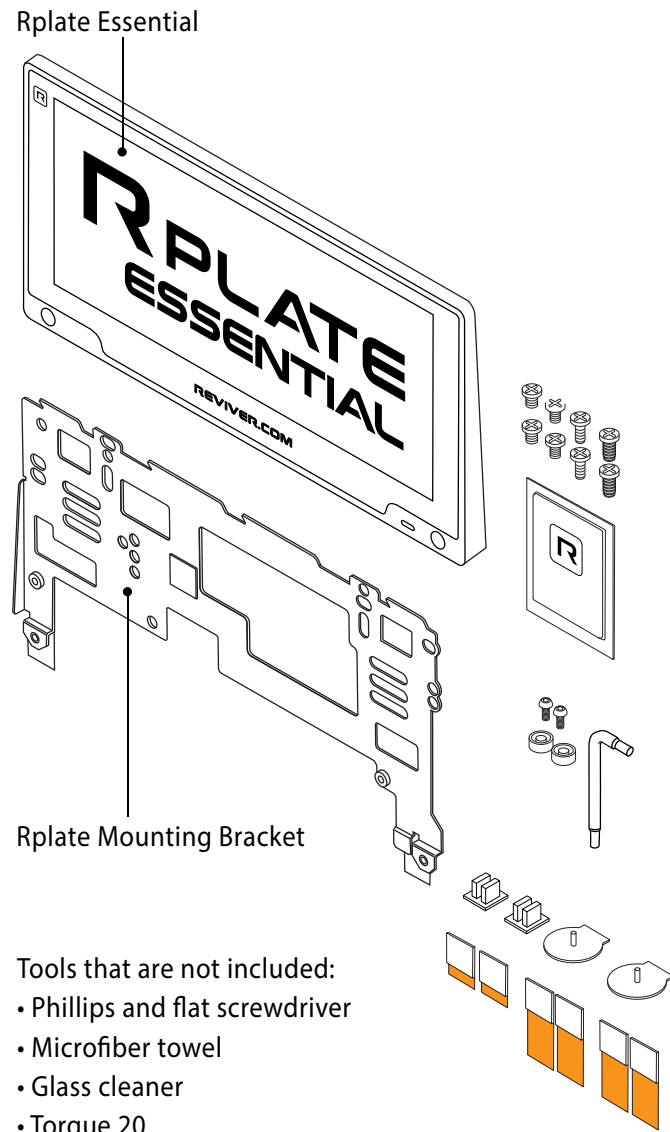

- Bag A:
- Alcohol wipe
 - Screws with colored dot:
 - Brown (2)
 - Blue (2)
 - Yellow(2)
 - Green(2)

- Bag B:
- Front Screws (2)
 - Rubber plugs (2)
 - L-wrench (T20)

- Bag C:
- Optional
- Spacers (2)
 - Plastic nuts (2)
 - Extra tape (6)

1. Remove metal license Plate

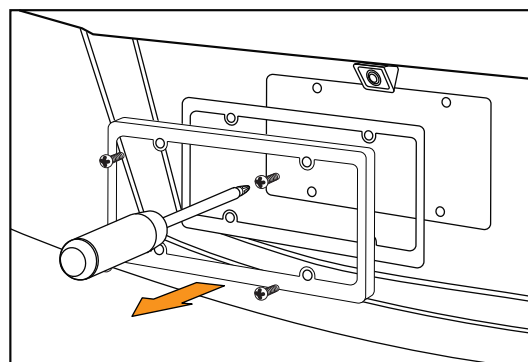

- Make sure to also remove:
- Plate, Frame and screws
 - Adaptors/ Brackets
 - Other materials such as foam or tape

! Some international models may require torque 20 tool to remove adaptor.

2. Prepare for installation

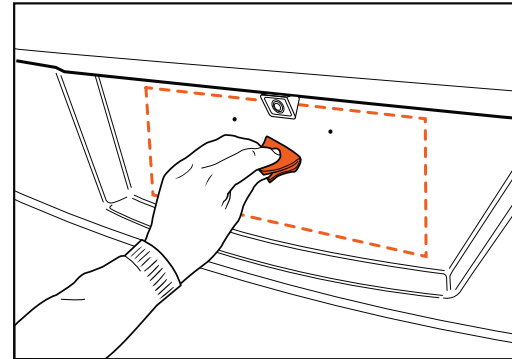

Clean surface with provided talcohol wipe.

! ON VEHICLES WITH SPECIAL COATING (CERAMIC, WRAP AND MATT FINISH), USE MICROFIBER TOWEL AND GLASS CLEANER.

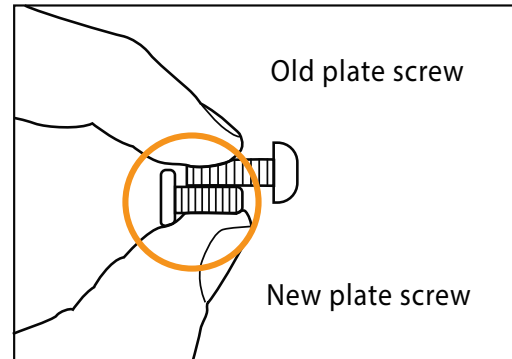

To choose the correct new screws, compare the old and new screw diameters.

! USE SUPPLIED SCREWS ONLY (BAG A)

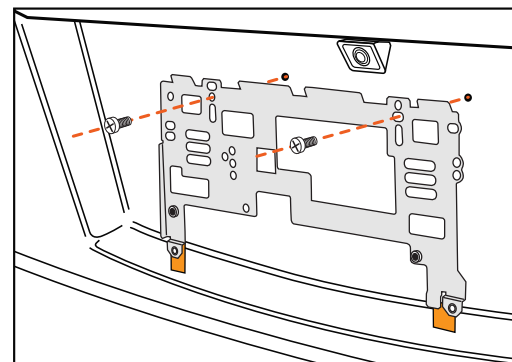

Mount the Rplate bracket with the correct screws. Make sure holes are aligned to prevent blocking camera.

Note: Phillips screwdriver needed. (Do not adhere the tape yet).

3. Test Fit Rplate

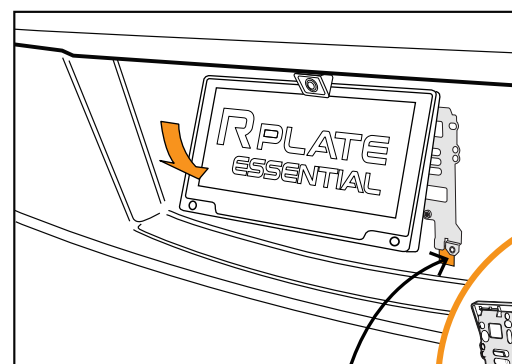

Slots on back of Rplate engage tabs on top edge of bracket.

Make sure Rplate bracket tape is flush to vehicle.

4. Install Rplate bracket

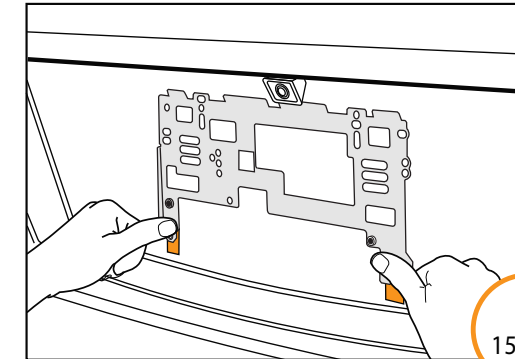

Remove Rplate

Pull red liners and press tape firmly to clean vehicle surface for 15 sec

Ensure screws are fully fastened.

15 sec

5. Install Rplate

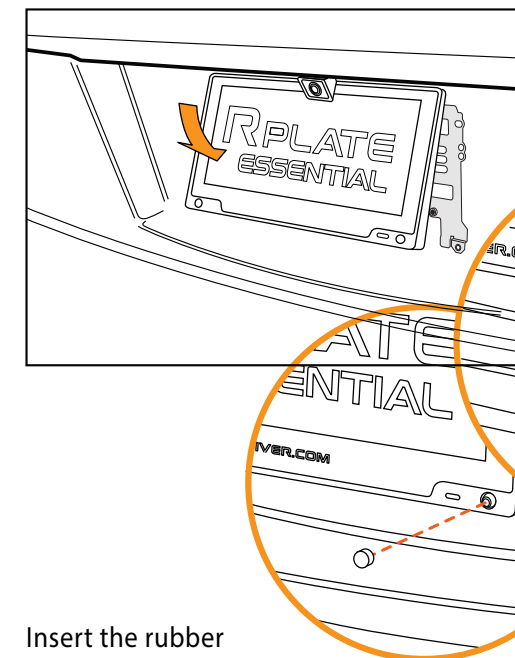

Install two screws using L-wrench (T20)

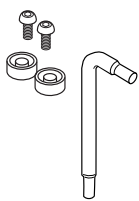

From bag B

Insert the rubber plugs, groove facing down.

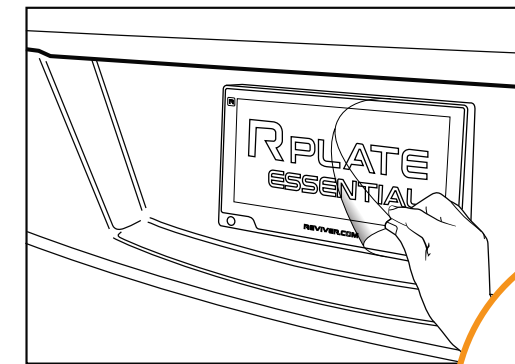

Remove plastic film.

Follow instructions in the app to complete pairing and setup.



This guide contains important information. Please keep it for future reference

Designed by Reviver in California. Assembled in Taiwan.
RPLATE is a registered trademark of Reviver © 2019 All rights reserve

Cautions and Warnings:

CAUTION: For the vehicles with paint protective film, ceramic coating or matt finish use soap, water and dry cloth to clean surface before installing license plate

CAUTION: Routinely check this product for proper and safe condition. If there is any damage or broken parts, remove product from use

CAUTION: If for any reason the screen (display) is fractured or cracked, immediately remove this product from use and contact Reviver Consumer Services for replacement if under warranty

CAUTION: The display module should not be exposed to harmful gases, such as acid and alkali gases, which corrode electronic components

CAUTION: Disassembling the display module can cause permanent damage and invalidate the warranty agreement

CAUTION: Observe general precautions that are common to handling delicate electronic components. The glass can break, and front surfaces can easily be damaged. Moreover, the display is sensitive to static electricity and other rough environmental conditions

WARNING: The display glass may break when it is dropped or bumped on a hard surface. Handle with care. Should the display break, do not touch the electrophoretic material. In case of contact with electrophoretic material, wash with water and soap

WARNING: This product contains chemicals known to the State of California to cause cancer and birth defects or other reproductive harm

NOTICE: Use mounting hardware sent with Rplate to attach mounting bracket. Wipe car surface prior to install. Ensure product installed correctly

NOTICE: Do not use product if it was damaged in the accident

NOTICE: Rplate is sold as rear license plate. Consult with applicable laws and regulations imposed by state agencies with respect of display of the front license plate

NOTICE: Additional tools may be required to remove the license plate, adaptor and foam

Battery replacement Instructions:

Rplate includes a non-rechargeable lithium battery pack designed by Reviver. For replacement, only use Reviver product. For further instruction, please go to www.reviver.com/legal

Battery safety

Dispose of used battery pack properly. Only batteries pack provided by Reviver is acceptable for replacement.

DO NOT incinerate used batteries.

DO NOT dispose of batteries in fire, as batteries may explode or leak.

DO NOT recharge non-rechargeable batteries

DO NOT short-circuit the supply terminals.

DO NOT expose to temperatures beyond the specified temperature range

DO NOT crush or puncture

DO NOT open cells, do not disassemble battery packs

DO NOT expose contents to water

DO NOT connect with false polarity

DO NOT weld or solder to the battery's body

FCC NOTICE:

This device complies with Part 15 of the FCC rules. Operation is subject to the following two conditions: 1) This device may not cause harmful interference, and 2) This device must accept any interference received, including interference that may cause undesired operation.

NOTE: This equipment has been tested and found to comply with the limits for a Class B digital device, pursuant to part 15 of the FCC Rules. These limits are designed to provide reasonable protection against harmful interference in a residential installation. This equipment generates uses and can radiate radio frequency energy and, if not installed and used in accordance with the instructions, may cause harmful interference to radio communications. However, there is no guarantee that interference will not occur in a particular installation. If this equipment does cause harmful interference to radio or television reception, which can be determined by turning the equipment off and on, the user is encouraged to try to correct the interference by one or more of the following measures:
Reorient or relocate the receiving antenna.
Increase the separation between equipment and receiver.
Consult the dealer or an experienced radio/TV technician for help.

Note: Changes or modifications to this unit not expressly approved by Reviver could void the user's authority to operate the equipment

FCC Declaration of Conformity
Trade Name: RPLATE
Model Number: ATT
Contains: FCC ID: XPY2AGQN4NNN
Contains: FCC ID: XPYNINAB1

Electronic waste: To recycle product, visit your local e-waste collection facility or local recycler. Reviver offers a mail-back program for its products. Reviver will ensure recycling and disposal are performed in an environmentally sound manner that complies with all governmental laws and regulations. To access the mail-back program reach out to the Reviver customer service.

Customer service contact: Contact our consumer support at www.reviver.com/contact or call 1-866-4-Rplate (1-866-477-5283).

Warranty: Subject to a limited two (2) year warranty. Visit Terms of Sale and Use for full details. Reviver shall not be liable for any incidental or consequential damages for the breach or any warranty on this product. Some jurisdictions do not allow the exclusion or limitation of incidental or consequential damages, or limitation on how long an implied warranty lasts, so the above limitations or exclusions may not apply to you



Essential

Installation & Set-up

REVIVER™