



BATTERY RPLATE

Installation + Setup Guide





**Welcome to the Reviver family!
We're thrilled to have you join us
on our journey to modernize the
way we experience driving. With
the RPLATE, you're not just
upgrading your vehicle; you're
entering a world of convenience,
personalization, and safety like
never before. Get ready to make
your driving experience truly
yours. Let's embark on this
exciting adventure together.**

Reviver App Setup

1



Download Reviver App

Download the Reviver app at the Apple App Store for you iPhone or the Google Play Store for your Android

2

Create Your Account

Create your Reviver account in the mobile app.

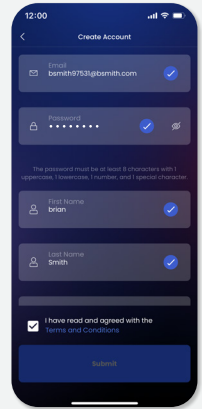
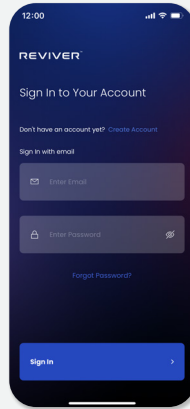

3

Add Vehicle

Tap the + icon to proceed

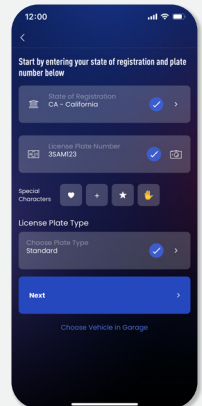
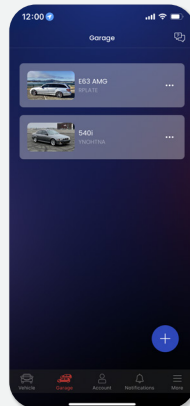

4

Add Your RPLATE To Your Account

Scan the serial number on the front top right corner of your plate and enter the email used when purchasing your RPLATE.

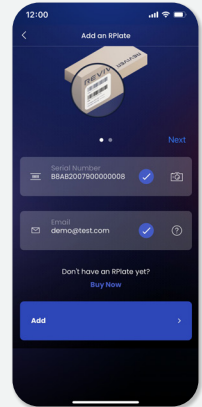
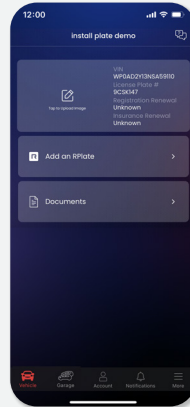

5

Set Up Your RPLATE

Follow the in-app instructions to setup your RPLATE and add your vehicle registration to the device. You will need to submit photos of your latest vehicle registration document and your license plate.

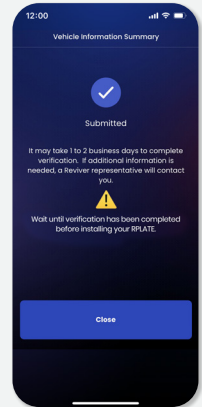
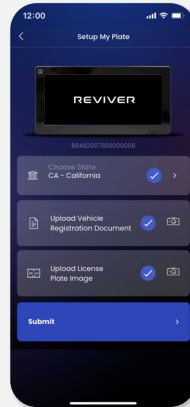
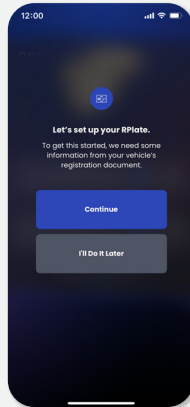

6

RPLATE Installation

Once our team has confirmed your vehicle and plate info, you will receive a notification by email and through your Reviver app to refresh your RPLATE and display your license plate image.

! Is Your RPLATE showing a "Detached" Message?

Make sure that it is in contact with the included metal bracket that you will attach to the rear of your car shortly. The RPLATE has an anti-theft sensor - attaching it to the bracket will allow you to complete step 6.

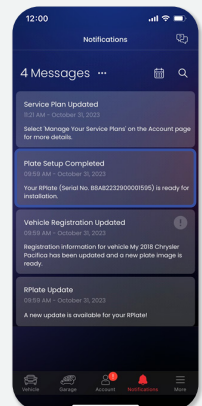

RPLATE Hardware Installation

Components In Kit

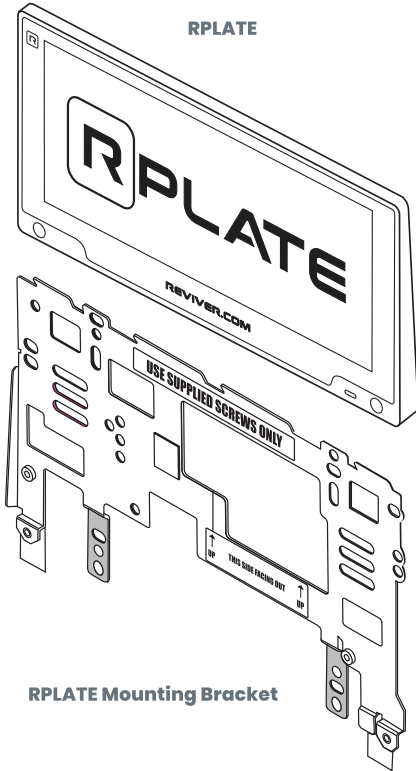

Bag A:

- Alcohol wipe
- Screws with colored dot:
 - Black - 4
 - Blue - 4
 - Brown - 4
 - Green - 4
 - White - 4
 - Yellow - 4

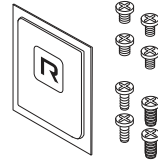

Bag B:

- Front screws - 2
- Rubber plugs - 2
- L-wrench (T-20)



Tools that are not included:

- Phillips + flat screwdriver
- Microfiber towel
- Glass cleaner

1

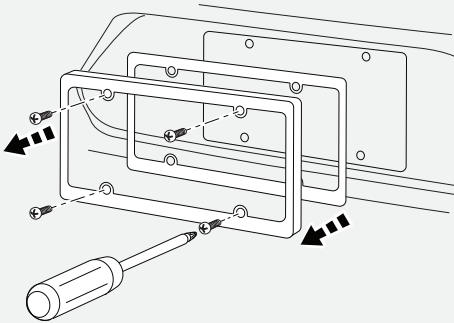

Remove Plate

Remove existing plate and all components, including any adhesive foam or tape.

2

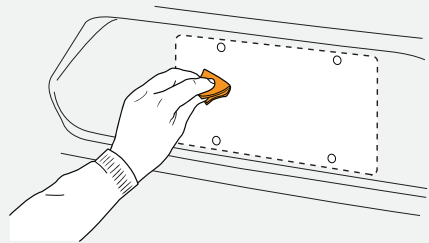

Clean Surface

Clean surface with alcohol wipe provided.

On vehicles with special coating (ceramic, wrap and matte finish), use microfiber towel and glass cleaner.

Note:

If your license plate is mounted to your vehicle with two screws,

CONTINUE TO STEP 3

If your license plate is mounted to your vehicle with four screws,

GO TO STEP 8

3



Old plate screw

New plate screw

Use supplied screws only (Bag A)

Selecting Screws

Choose the correct new screws by comparing the old and new screw diameter

4

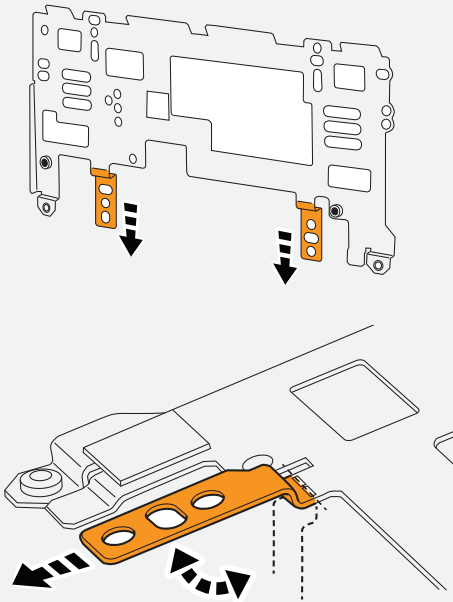

Break off this direction

Snap Off Lower Screw Mounts

Take the included bracket and snap off lower screw mounts. Bend the lower two tabs 90 degrees towards the side of the bracket with writing on the stickers, then return to original position and repeat until they break free.

5

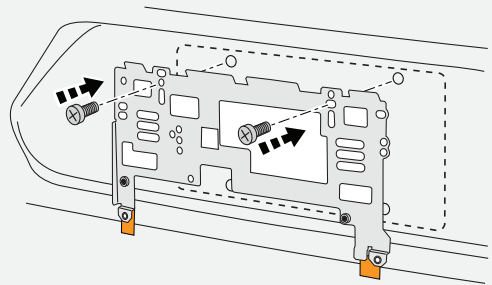

Mount the RPLATE Bracket

Mount the RPLATE bracket with the correct screws. Make sure holes are aligned properly.

In the set of 3 vertical holes at the top, start by trying to mount the bracket using the middle holes as shown in the image. If you need to adjust the bracket up or down based on space available in your license plate area, use the holes immediately above or below.

6

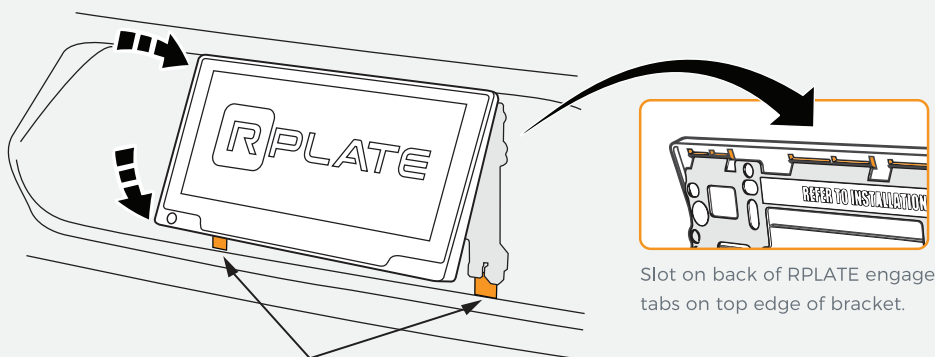

Slot on back of RPLATE engage tabs on top edge of bracket.

Test Fit the RPLATE

Make sure RPLATE bracket tape is flush to vehicle so that the adhesive strip will attach properly. If necessary for a better fit, adjust the bracket up or down as mentioned in step 5.

7

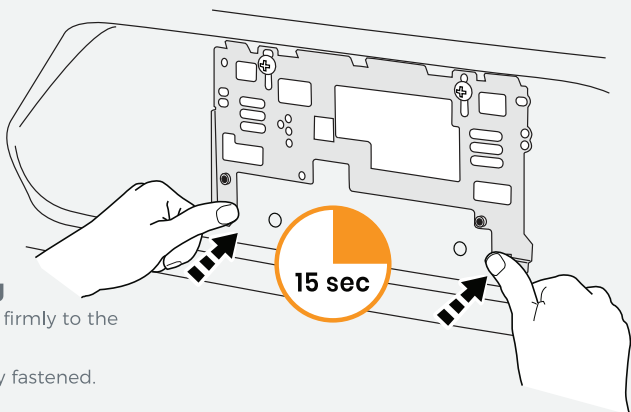

Complete Bracket Mounting

Pull the red liners and press tape firmly to the clean vehicle surface for 15 sec

NOTE: Be sure the screws are fully fastened.

PROCEED TO STEP 12

8



Old plate screw

New plate screw

Use supplied screws only (Bag A)

Selecting Screws

Choose the correct new screws by comparing the old and new screw diameter

9

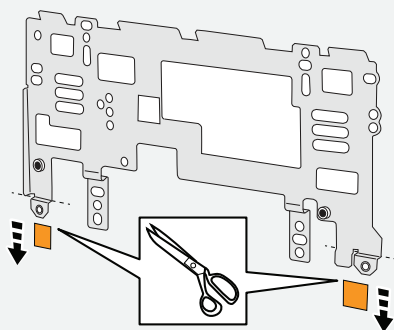

Cut Off Flaps

Snip off the bottom of the red cover flaps so that it won't be visible below the plate. Leave the cover flaps on the adhesive behind the plate.

10

Mount the RPLATE bracket with the correct screws. Make sure holes are aligned properly.

In the set of 3 vertical holes at the top, start by trying to mount the bracket using the middle holes as shown in the image. If you need to adjust the bracket up or down, based on space available in your license plate area, use the holes immediately above or below.

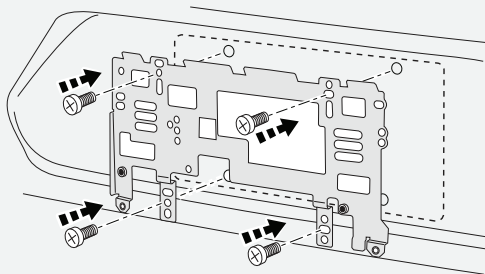

11

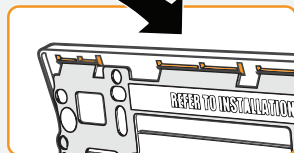
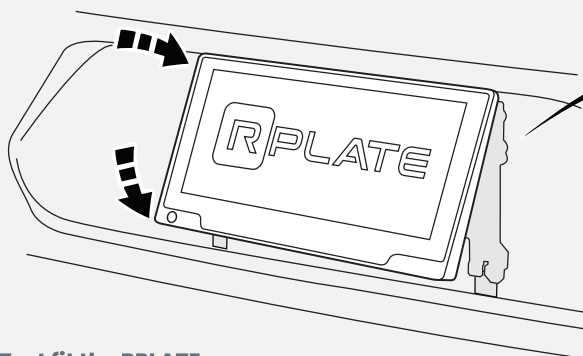

Slot on back of RPLATE engage tabs on top edge of bracket.

Test fit the RPLATE

Make sure the RPLATE fits well within the license plate mounting area on your vehicle. If necessary, adjust the bracket up or down as mentioned in step 10.

12

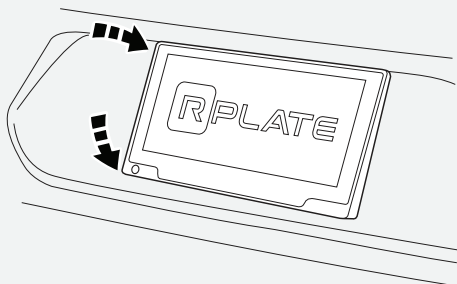
**Reinstall the RPLATE**

13

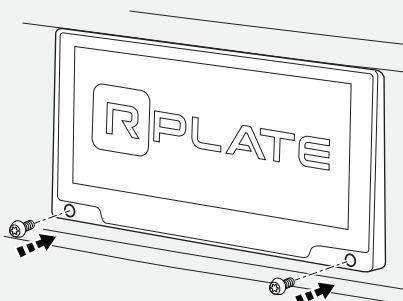
**Install two screws from Bag B**

14

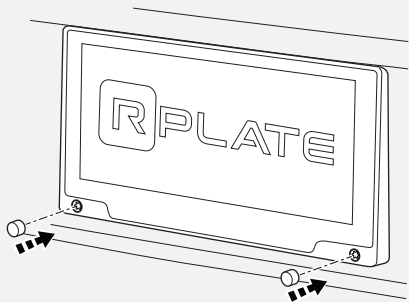

Insert the rubber plugs from Bag B, with groove facing down.

15

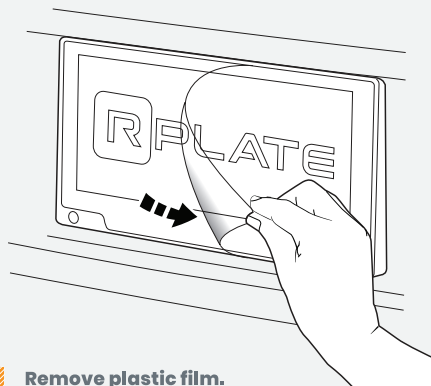

Remove plastic film.

16



Follow instructions in the app to complete pairing and setup.



**You're now ready to hit the road!
Say goodbye to the hassles of
traditional license plates and
embrace the future of driving!**

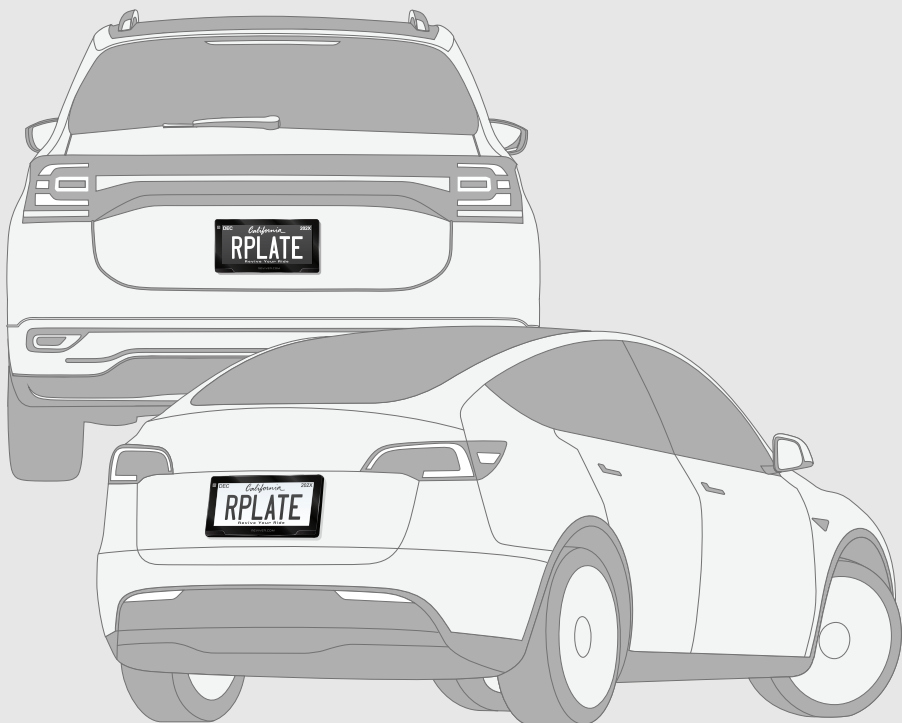

Reviver Support

Comprehensive support information is available online at support.reviver.com.

To contact Reviver for personalized support email support@reviver.com or call (866) 477-5283.

This guide contains important information. Please keep it for future reference.

Designed by Reviver in California. Assembled in Taiwan. RPLATE is a registered trademark of Reviver© 2019 All rights reserved.

! CAUTIONS + WARNINGS

CAUTION: For vehicles with paint protective film, ceramic coating or matte finish use soap, water and dry cloth to clean surface before installing license plate.

CAUTION: Routinely check this product for proper and safe condition. If there is any damage or broken parts, remove product from use.

CAUTION: If for any reason the screen (display) is fractured or cracked, immediately remove this product from use and contact Reviver Consumer Services for replacement if under warranty.

CAUTION: The display module should not be exposed to harmful gases, such as acid and alkali gases, which corrode electronic components.

CAUTION: Disassembling the display module can cause permanent damage and invalidate the warranty agreement.

CAUTION: Observe general precautions that are common to handling delicate electronic components. The glass can break, and front surfaces can easily be damaged. Moreover, the display is sensitive to static electricity and other rough environmental conditions.

WARNING: The display glass may break when it is dropped or bumped on a hard surface. Handle with care. Should the display break, do not touch the electrophoretic material. In case of contact with electrophoretic material, wash with water and soap.

WARNING: This product contains chemicals known to the State of California to cause cancer and birth defects or other reproductive harm.

NOTICE: Use mounting hardware sent with RPLATE to attach mounting bracket. Wipe car surface prior to install. Ensure product installed correctly.

NOTICE: Do not use product if it was damaged in an accident.

NOTICE: RPLATE is sold as rear license plate. Consult with applicable laws and regulations imposed by state agencies with respect of display of the front license plate.

NOTICE: Tools may be required to remove the license plate, adapter, and foam.

Battery replacement instructions:

RPLATE includes a non-rechargeable lithium battery pack designed by Reviver. For replacement, only use Reviver products. For further instruction, please go to www.reviver.com/legal.

Battery safety:

Dispose of used battery pack properly. Only battery pack provided by Reviver is acceptable for replacement.

DO NOT incinerate used batteries.

DO NOT dispose of batteries in fire, as batteries may explode or leak.

DO NOT recharge non-rechargeable batteries.

DO NOT short-circuit the supply terminals.

DO NOT expose to temperatures beyond the specified temperature range.

DO NOT crush or puncture.

DO NOT open cells, do not disassemble battery packs.

DO NOT expose contents to water.

DO NOT connect with false polarity.

DO NOT weld or solder to the battery's body.

FCC NOTICE:

This device complies with Part 15 of the FCC rules. Operation is subject to the following two conditions: 1) This device may not cause harmful interference, and 2) This device must accept any interference received, including interference that may cause undesired operation.

NOTE: This equipment has been tested and found to comply with the limits for a Class B digital device, pursuant to part 15 of the FCC Rules. These limits are designed to provide reasonable protection against harmful interference in a residential installation. This equipment generates uses and can radiate radio frequency energy and, if not installed and used in accordance with the instructions, may cause harmful interference to radio communications. However, there is no guarantee that interference will not occur in a particular installation. If this equipment does cause harmful interference to radio or television reception, which can be determined by turning the equipment off and on, the user is encouraged to try to correct the interference by one or more of the following measures:

- Reorient or relocate the receiving antenna.
- Increase the separation between equipment and receiver.
- Consult the dealer or an experienced radio/TV technician for help.

NOTE: Changes or modifications to this unit not expressly approved by Reviver could void the user's authority to operate the equipment.

FCC Declaration of Conformity

Trade Name: RPLATE

Model Number: ATT

Contains: FCC ID: XPY2AGQN4NNN

Contains: FCC ID: XPYNINABI

Electronic waste: To recycle product, visit your local e-waste collection facility or local recycler. Reviver offers a mail-back program for its products. Reviver will ensure recycling and disposal are performed in an environmentally sound manner that complies with all governmental laws and regulations. To access the mail-back program, reach out to the Reviver customer service.

Customer service contact: Contact our consumer support at support@reviver.com.

Warranty: Subject to a limited two (2) year warranty. Visit Terms of Sale and Use for full details. Reviver shall not be liable for any incidental or consequential damages for the breach or any warranty on this product. Some jurisdictions do not allow the exclusion or limitation of incidental or consequential damages, or limitation on how long an implied warranty lasts, so the above limitations or exclusions may not apply to you.

